



Installation Instructions

718102

Direct Fit Muffler

2017-2026 Ford F250/F350

6.2L, 6.8L, 7.3L Engine

All wheel Bases

Installation requires moderate mechanical skill. If this job is beyond your abilities, seek the services of a qualified technician.

NOTE: Cutting the OEM tail pipe is required.

If you do not understand any part of these instructions, please call Flowmaster Technical Support at (866) 464-6553 for assistance.

Apply penetrating oil generously to clamps, fasteners, pipes, and hanger rods for ease of disassembly.

REVIEW THE INSTRUCTIONS & VERIFY THE KIT CONTENTS

Take a moment to read and understand these instructions before installing your Flowmaster exhaust kit.

ITM#	Part #	Description	Qty.
1	71461-629	Direct Fit Muffler Assembly	1
2	MC350BS	3.0" Band Clamp	1
3	MC300BS	3.5" Band Clamp	1

Use the parts drawing and list to identify components and verify your kit's contents. In the unlikely event that any parts are missing, please contact Flowmaster Technical Support for replacements.

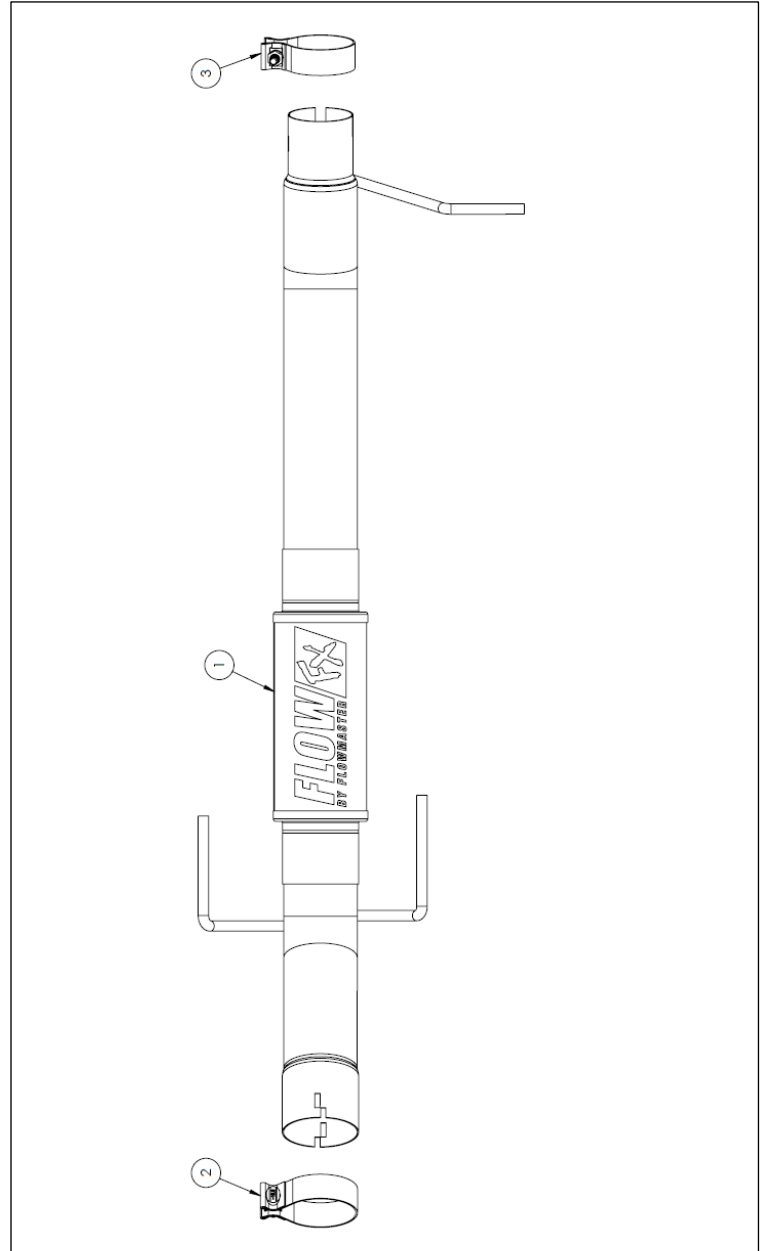

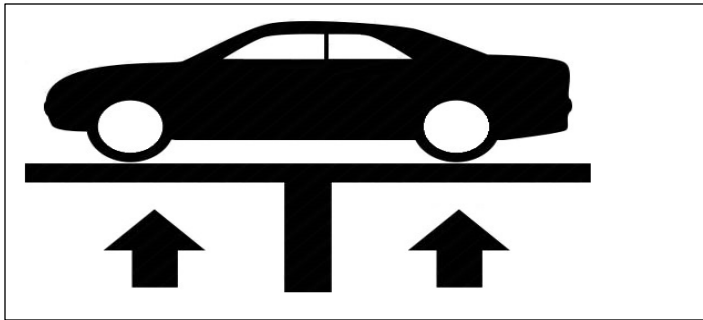

Vehicle Compatibility

Model Year: 2017-2026

Make: Ford

Model: F250/F350

Engine: 6.2L, 6.8L, 7.3L

- Fits All Wheel Bases

- *Will not fit Dual Rear Wheel trucks

BEFORE STARTING:

Raise the vehicle to a minimum of eighteen inches. A floor hoist is ideal. If no hoist is available, we strongly urge the use of axle stands as a safety measure. **Please read and understand these instructions and disclaimer completely before attempting installation.**

CAUTION! WORK ONLY ON A LEVEL SURFACE. USE JACKS /JACK STANDS OF SUFFICIENT CAPACITY TO LIFT AND SUPPORT YOUR VEHICLE. NEVER WORK UNDER A VEHICLE SUPPORTED BY A FLOOR OR BUMPER JACK

Removing the OEM Muffler Assembly - Fig.1

NOTE: Cutting the factory exhaust is necessary. Please read and follow all the instructions before attempting to install this exhaust system.

1. Loosen the clamp at the muffler inlet (A). **Fig.1**
2. Remove the x4 bolts at the rear most tail pipe hanger assembly on the frame rail and support the tail pipe.
3. Remove the Rubber Isolators at the muffler outlet or unbolt the hanger bracket from the Tail Pipe.
4. Remove the two bolts from the front muffler hanger on the frame rail.
5. Pull the muffler and tail pipe assembly rearward to remove the inlet pipe from the resonator. **Do not remove the secondary resonator if equipped. SUPPORT THE MUFFLER WHEN SEPARATED**

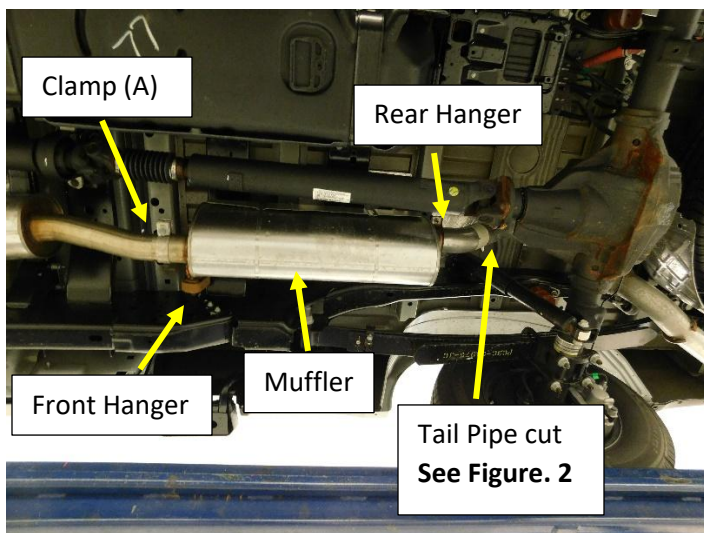

Figure.1

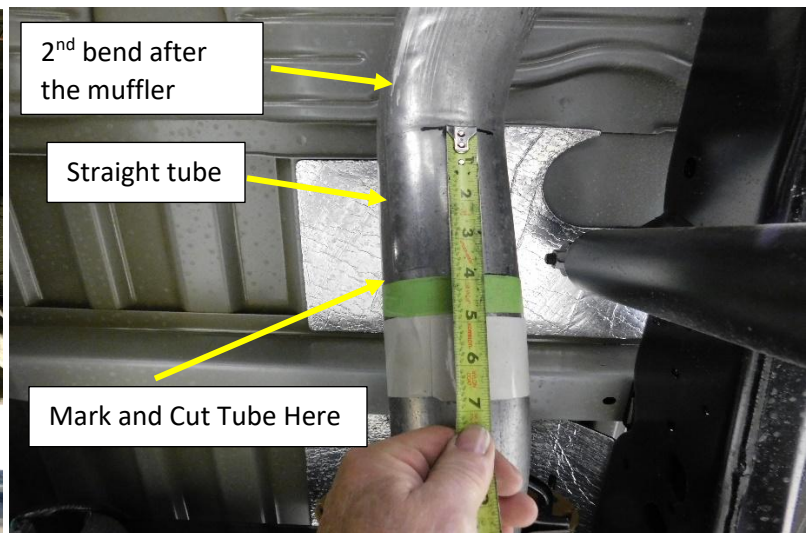

Figure. 2

6. Mark the tail pipe at 4" down (towards the muffler) from the intersection of the second bend and the straight tube. **Fig. 1 / Fig.2**
7. Wrap the pipe with masking tape at 4" to create a straight edge to follow when making the cut. **Carefully cut the tail pipe at the top edge of the masking tape and remove the muffler.**
8. Deburr the tail pipe inside and out.

Installation of 718102 Direct Fit Muffler

1. Install the Supplied 3.0" band clamp **(3)** onto the reduced and notched inlet end of the Flowmaster Direct Fit Muffler assembly **(1)**. **Fig.3**
2. Install the mufflers reduced and notched Inlet end on to the OEM Muffler Inlet pipe (resonator), with the square notch aligned with the pin on the inlet pipe. Be sure the pin is in the notch completely.
3. First install the (x2) isolators on to the hanger rods at the muffler outlet. 2nd, Install the isolator assembly at the Muffler inlet with the (x2) OEM bolts into the frame.
4. Install the supplied 3.5" band Clamp **(2)** on to the expanded and notched direct fit muffler outlet.
5. Install the OEM tail pipe into the expanded and notched direct fit muffler outlet.
6. Install the tail pipe Isolator on to the Hanger rod and install the x4 bolts at the rear of the frame rail.
7. Check alignment and tighten the clamps.

Important: Make sure the Inlet pipe clamp **(3)** is installed just past the alignment pin on the inlet pipe and NOT on top of it. This will prevent a loose connection possible exhaust leak.

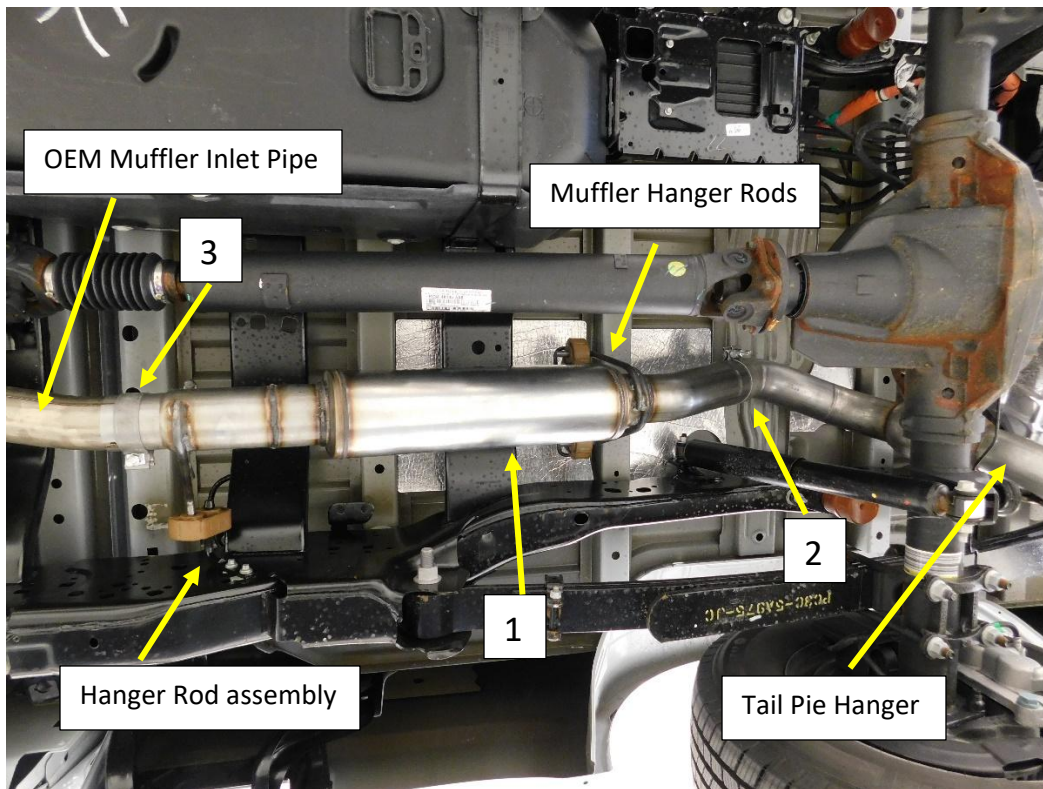

Figure. 3

Enjoy Your Flowmaster Exhaust!

